

# User Manual

Revision v1.2 December 2010

## ***EVO-TP2A***

## ***Hardware***

## ***System***

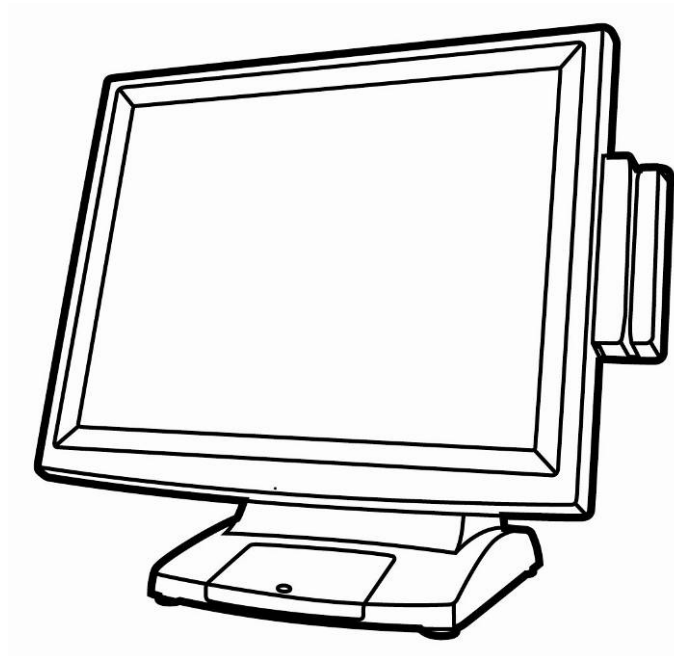

Copyright 2010 December  
All Rights Reserved  
Manual Version 1.2  
Part Number:

The information contained in this document is subject to change without notice.

We make no warranty of any kind with regard to this material, including, but not limited to, the implied warranties of merchantability and fitness for a particular purpose. We shall not be liable for errors contained herein or for incidental or consequential damages in connection with the furnishing, performance, or use of this material.

This document contains proprietary information that is protected by copyright. All rights are reserved. No part of this document may be photocopied, reproduced or translated to another language without the prior written consent of the manufacturer.

## **TRADEMARK**

Intel®, Pentium® and MMX are registered trademarks of Intel® Corporation. Microsoft® and Windows® are registered trademarks of Microsoft Corporation.

Other trademarks mentioned herein are the property of their respective owners.

# Safety

## IMPORTANT SAFETY INSTRUCTIONS

1. To disconnect the machine from the electrical Power Supply, turn off the power switch and remove the power cord plug from the wall socket. The wall socket must be easily accessible and in close proximity to the machine.
2. Read these instructions carefully. Save these instructions for future reference.
3. Follow all warnings and instructions marked on the product.
4. Do not use this product near water.
5. Do not place this product on an unstable cart, stand, or table. The product may fall, causing serious damage to the product.
6. Slots and openings in the cabinet and the back or bottom are provided for ventilation; to ensure reliable operation of the product and to protect it from overheating. These openings must not be blocked or covered. The openings should never be blocked by placing the product on a bed, sofa, rug, or other similar surface. This product should never be placed near or over a radiator or heat register, or in a built-in installation unless proper ventilation is provided.
7. This product should be operated from the type of power indicated on the marking label. If you are not sure of the type of power available, consult your dealer or local power company.
8. Do not allow anything to rest on the power cord. Do not locate this product where persons will walk on the cord.
9. Never push objects of any kind into this product through cabinet slots as they may touch dangerous voltage points or short out parts that could result in a fire or electric shock. Never spill liquid of any kind on the product.

## CE MARK



This device complies with the requirements of the EEC directive 2004/108/EC with regard to “Electromagnetic compatibility” and 2006/95/EC “Low Voltage Directive”

## FCC

This device complies with part 15 of the FCC rules. Operation is subject to the following two conditions:

- (1) This device may not cause harmful interference.
- (2) This device must accept any interference received, including interference that may cause undesired operation

## CAUTION ON LITHIUM BATTERIES

There is a danger of explosion if the battery is replaced incorrectly. Replace only with the same or equivalent type recommended by the manufacturer. Discard used batteries according to the manufacturer's instructions.

## LEGISLATION AND WEEE SYMBOL

2002/96/EC Waste Electrical and Electronic Equipment Directive on the treatment, collection, recycling and disposal of electric and electronic devices and their components.

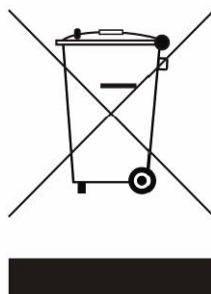

The crossed dustbin symbol on the device means that it should not be disposed of with other household wastes at the end of its working life. Instead, the device should be taken to the waste collection centers for activation of the treatment, collection, recycling and disposal procedure.

To prevent possible harm to the environment or human health from uncontrolled waste disposal, please separate this from other types of wastes and recycle it responsibly to promote the sustainable reuse of material resources.

Household users should contact either the retailer where they purchased this product, or their local government office, for details of where and how they can take this item for environmentally safe recycling.

Business users should contact their supplier and check the terms and conditions of the purchase contract.

This product should not be mixed with other commercial wastes for disposal.

# Revision History

Changes to the original user manual are listed below:

Revision	Date	Description
V1.0	Aug, 2009	● Release
V1.1	Oct. 2009	● Correct Cash drawer / Bit 6: "Cash Drawer DIN bit0" pin out control → "Pin input status" ● Add Power Switch Notice.
V1.2	Dec.2010	● Model name change

# Table Contents

<b>1 Item Checklist .....</b>	<b>1</b>
1-1 Standard Items .....	1
1-2 Optional Items .....	2
<b>2 System View.....</b>	<b>3</b>
2-1 Front View .....	3
2-2 Rear View.....	4
2-3 Bottom View .....	5
2-4 I/O View.....	6
<b>3 Peripheral Installation .....</b>	<b>7</b>
3-1 MSR .....	7
3-2 VFD.....	8
3-3 Second Display .....	10
3-4 Cash Drawer .....	13
3-5 Wall Mount Kit .....	15
<b>4 System Assembly &amp; Disassembly .....</b>	<b>17</b>
4-1 Replace the HDD .....	17
4-2 Replace the Power Adapter.....	18
4-3 Remove the System Stand.....	18
<b>5 Specification .....</b>	<b>19</b>
<b>6 Jumper Settings .....</b>	<b>2</b>
6-1 C36A V1.1 Motherboard Layout .....	2
6-2 Connectors Description .....	3

6-3 Jumper Settings .....	4
<b>7 BIOS Settings.....</b>	<b>8</b>
<b>Appendix A: Important Notice of Power Switch .....</b>	<b>10</b>
<b>Appendix B: Drivers Installation: .....</b>	<b>12</b>

# 1

## Item Checklist

Take the system unit out of the carton. Remove the unit from the carton by holding it by the foam inserts. The following contents should be found in the carton:

### 1-1 Standard Items

a.

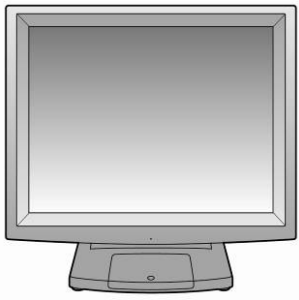

c.

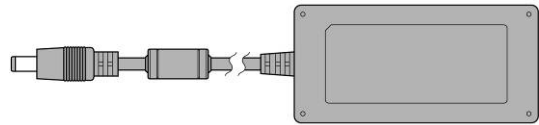

b.

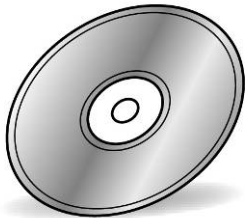

d.

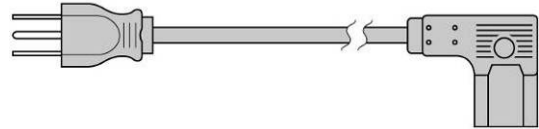

e.



- a. System
- b. Driver CD
- c. Power Adapter (65W)
- d. Power Cable
- e. COM-RJ45 Cable (x2)

# 1-2 Optional Items

a.

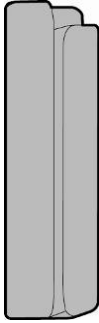

c.

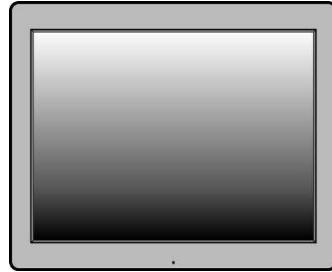

b.



d.

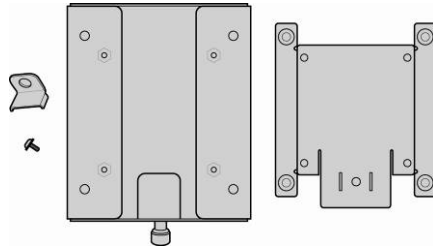

- a. MSR Module
- b. VFD Module
- c. Second Display
- d. Wall Mount Kit

# 2 System View

## 2-1 Front View

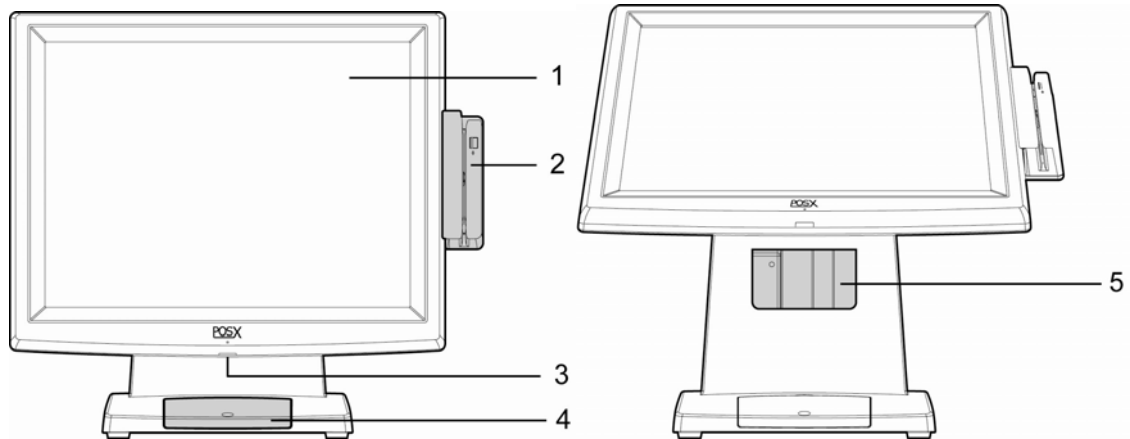

System Overview table -1

Number	Component
1	Touch Screen
2	MSR Module (Option)
3	Power Switch
4	Hard Disk Drive Cover
5	Stand hole for cable management

# 2-2 Rear View

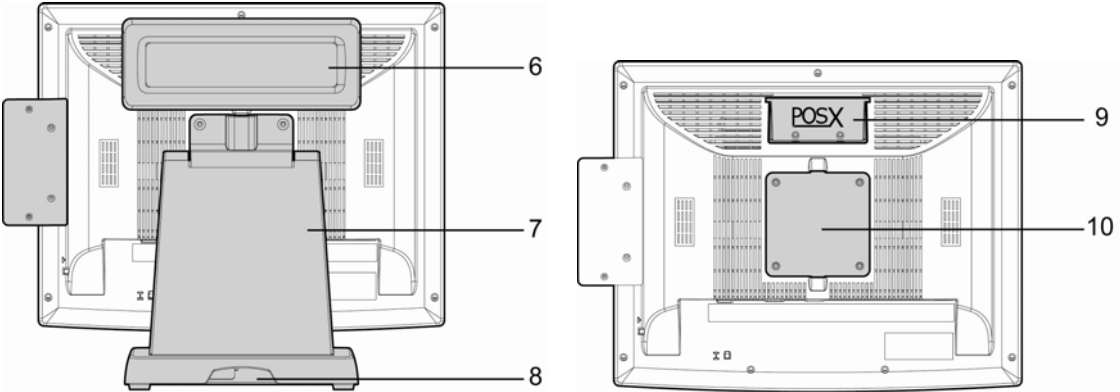

System Overview table -2

Number	Component
6	VFD Module (Option)
7	Stand with cable management and power adapter holder bracket
8	Cable outlet
9	VFD Cover
10	VESA hole for stand and wall-mount kit installation

# 2-3 Bottom View

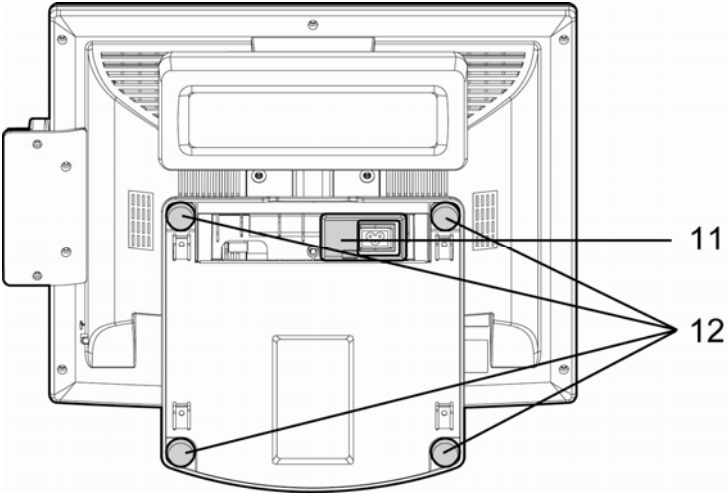

System Overview table -3

Number	Component
11	Easy-Service Retaining Bracket for Power Adapter
12	Rubber foot

## 2-4 I/O View

Below diagram shows the I/O view of C36 motherboard.

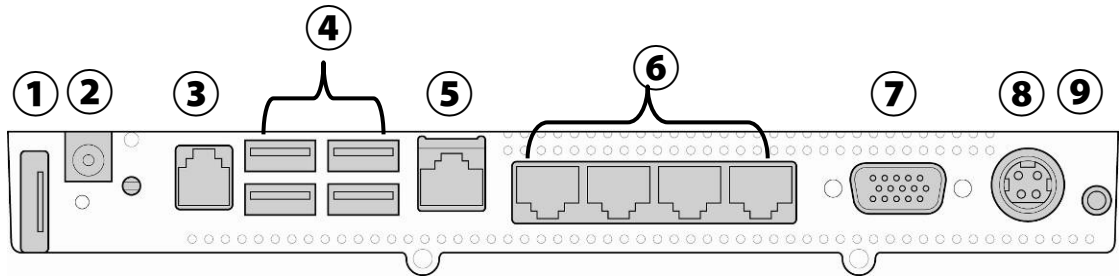

System Overview table -4

Number	Component
1	E-SATA connector
2	Power Jack for HDD
3	Cash Drawer
4	USB x 4
5	LAN
6	COM1~4 (from let to right)
7	VGA
8	Power Jack for System
9	Power Button

**Note:** The maximum current that can be drawn from each COM port is 500 mA.

# 3

## Peripheral Installation

The peripheral and modules units provided are tested and can be supplied at your request.

### 3-1 MSR

Components of MSR Kit:

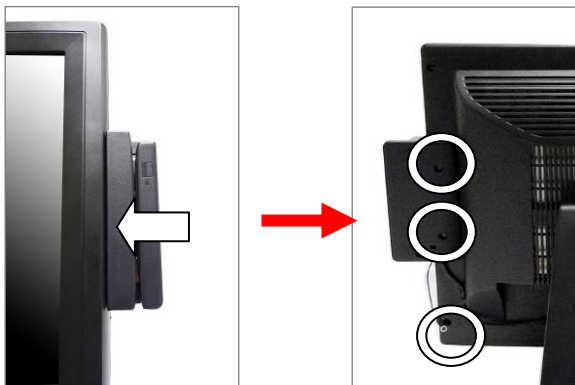
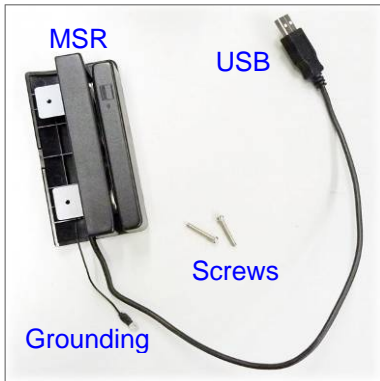

1. Slide the MSR into the right position of the System.
2. Fasten the screws (x2) and grounding cable (x1).

## 3-2 VFD

Components of VFD Kit:

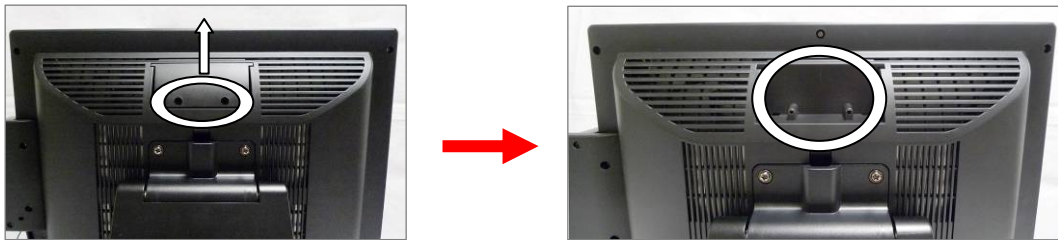
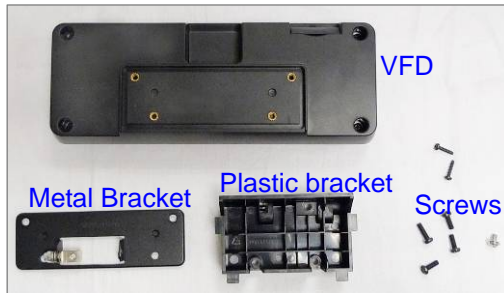

1. Unfasten the screws (x2) and slide the VFD Cover outward.

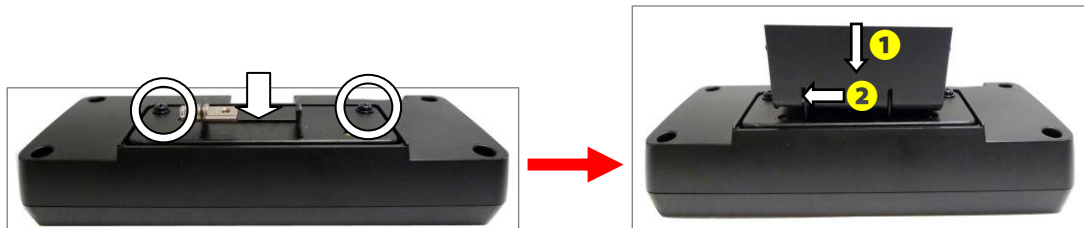

2. Position the VFD metal bracket onto the rear side of the VFD module and fasten the screws (x2).
3. Position the plastic bracket onto the metal bracket as the direction and steps of arrows show.

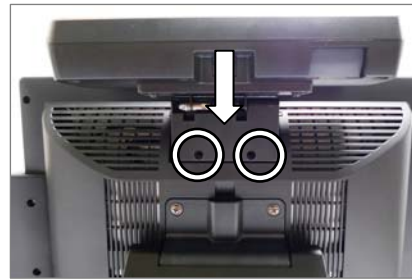
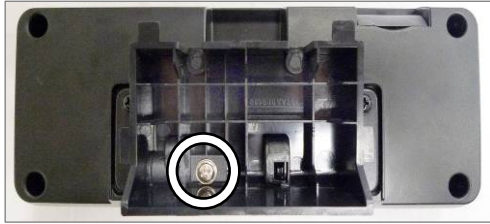

4. Fasten the screw (x1) to fix the plastic bracket to the metal bracket and VFD module.
5. Slide the MSR module with bracket into the VFD socket.
6. Fix the MSR module by fasten the screws (x2) as circles show.



7. Connect the VFD cable to the VFD Module.



8. Connect to the COM4 port of the System.
- Note: Please make sure system is powered down before plugging in the VFD.

## 3-3 Second Display

To install the Second Display, please open the VFD cover first (Chapter 3-2-1).

Components of Second Display Kit with power adapter:

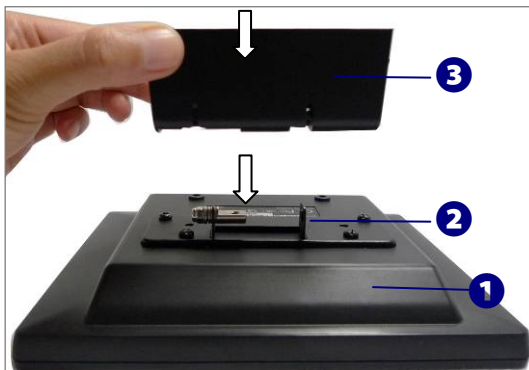
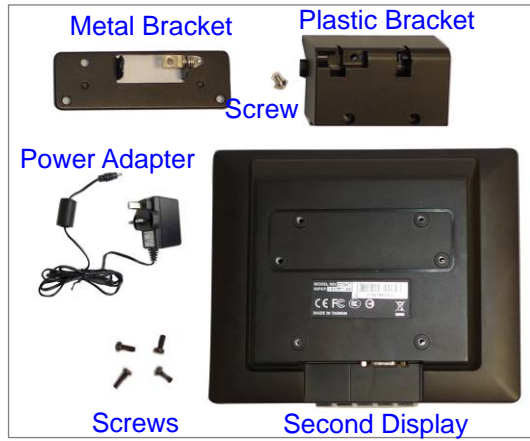

1. Attach the parts of the Second Display as shown in steps ① → ② → ③
  - ① Put the second display upside down.
  - ② Place the metal bracket onto the rear side of the second display and fasten the screws (x4) to fix metal bracket with the system.

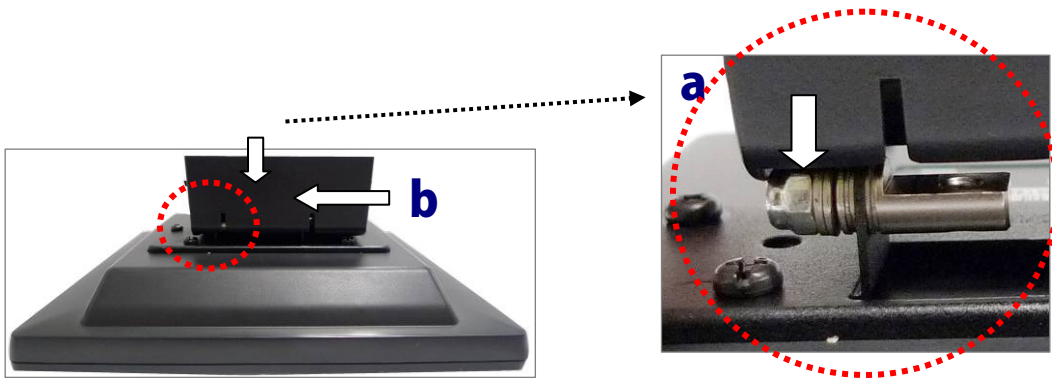

- ③ Align the plastic bracket into the right position of metal bracket.
- (a) Align the plastic bracket onto the metal bracket.
  - (b) Push to left until the click sound appears.

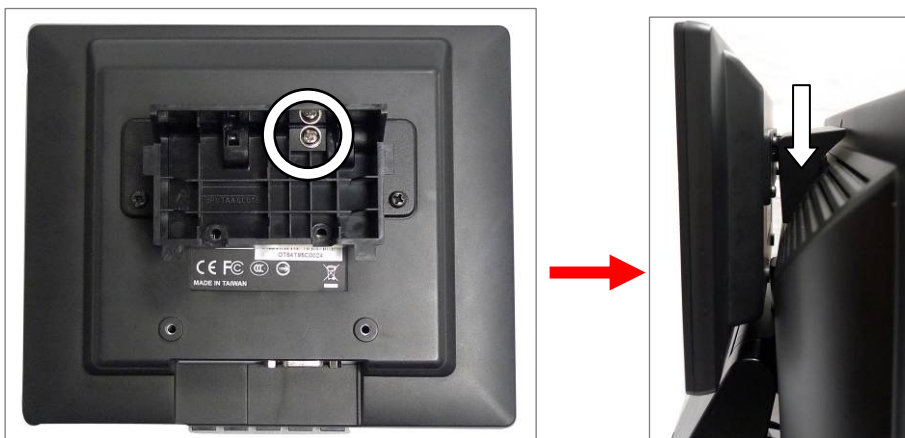

2. Fasten the screw (x1) to fix the plastic bracket and Second Display module with metal bracket.
3. Slide the Second Display Module into the slot.

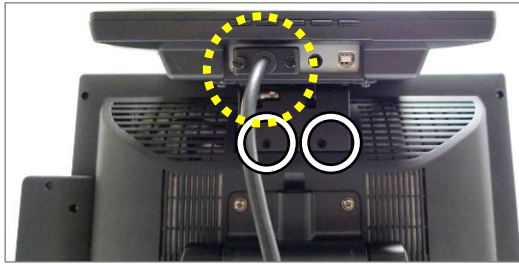

4. Fasten the screws (x2) to attach the Second Display module with the System.
5. Connect the VGA cable to the Second Display Module and the System.



6. Finish.

# 3-4 Cash Drawer

You can install a cash drawer through the cash drawer port. Please verify the pin assignment before installation.

## Cash Drawer Pin Assignment

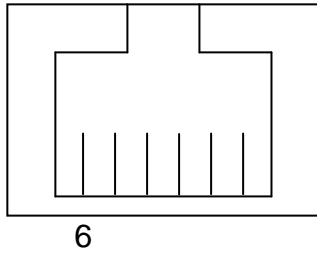

Pin	Signal
1	GND
2	DOUT bit0
3	DIN bit0
4	12V / 19V
5	DOUT bit1
6	GND

## Cash Drawer Controller Register

The Cash Drawer Controller uses one I/O address to control the Cash Drawer.

**Register Location:** 48Ch

**Attribute:** Read / Write

**Size:** 8bit

BIT	BIT7	BIT6	BIT5	BIT4	BIT3	BIT2	BIT1	BIT0
Attribute	Reserved		Read	Reserved	Write		Reserved	

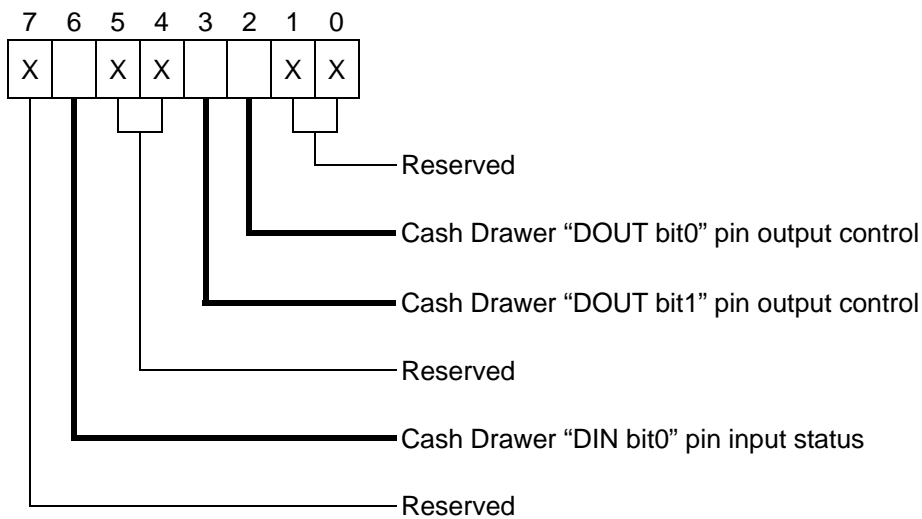

Bit 7: Reserved

Bit 6: Cash Drawer "DIN bit0" pin input status.

= 1: the Cash Drawer closed or no Cash Drawer

= 0: the Cash Drawer opened

Bit 5: Reserved

Bit 4: Reserved

Bit 3: Cash Drawer "DOOUT bit1" pin output control.

= 1: Opening the Cash Drawer

= 0: Allow close the Cash Drawer

Bit 2: Cash Drawer "DOOUT bit0" pin output control.

= 1: Opening the Cash Drawer

= 0: Allow close the Cash Drawer

Bit 1: Reserved

Bit 0: Reserved

Note: Please follow the Cash Drawer control signal design to control the Cash Drawer.

### Cash Drawer Control Command Example

Use Debug.EXE program under DOS or Windows98

Command	Cash Drawer
O 48C 04	Opening
O 48C 00	Allow to close
<p>➤ Set the I/O address 48Ch bit2 =1 for opening Cash Drawer by "DOOUT bit0" pin control.</p> <p>➤ Set the I/O address 48Ch bit2 = 0 for allow close Cash Drawer.</p>	

Command	Cash Drawer
I 48C	Check status
<p>➤ The I/O address 48Ch bit6 =1 mean the Cash Drawer is opened or not exist.</p> <p>➤ The I/O address 48Ch bit6 =0 mean the Cash Drawer is closed.</p>	

## 3-5 Wall Mount Kit

Before installing the Wall Mount Kit, please remove the stand first if needed.  
(See Chapter 4-3 for removing the stand)

(Parts of Wall Mount Kit)

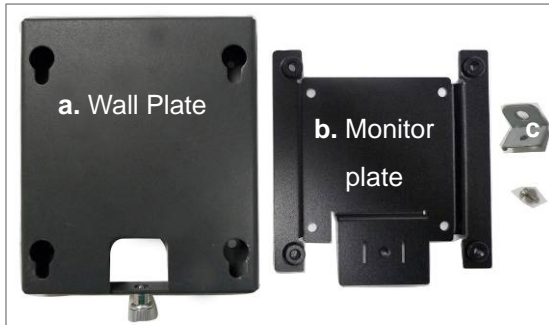

(Place to install)



1. Components of the VESA-standard wall mount kit includes the followings.
  - a. Wall-mounting plate
  - b. Monitor-mounting plate & screws
  - c. Screw metal bracket
2. The wall mount Kit installation is at the rear side of the system.

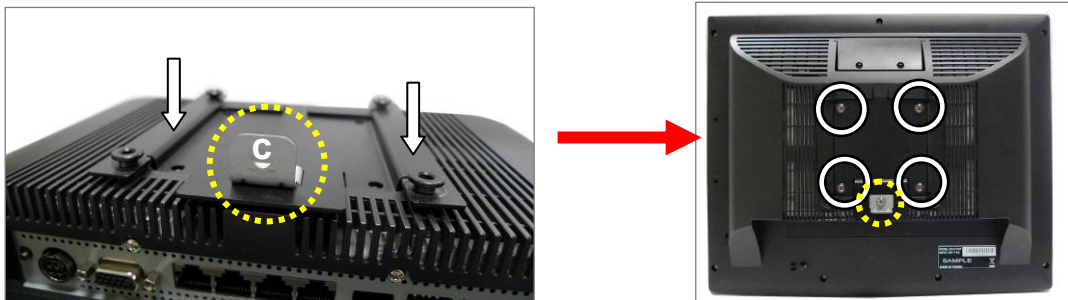

3. Place "b" which has 4 fixed hooks onto the rear side of the LCD rear cover.
4. Place "c" into the hole of the monitor plate as pictured and fasten the screw (x1).
5. Fasten the screws (x4) to attach the monitor plate.

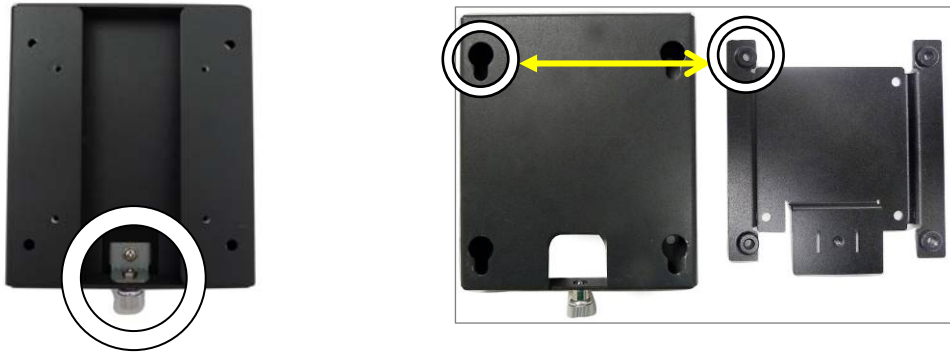

6. Attach “a” on the wall at your request.
7. Fasten the thumb screw (x1).
8. Align the hooks of the “monitor plate” with the keyholes of the “wall plate”.

# 4 System Assembly & Disassembly

## 4-1 Replace the HDD



1. Unfasten the screw (x1).
2. Slide out the HDD Cover.

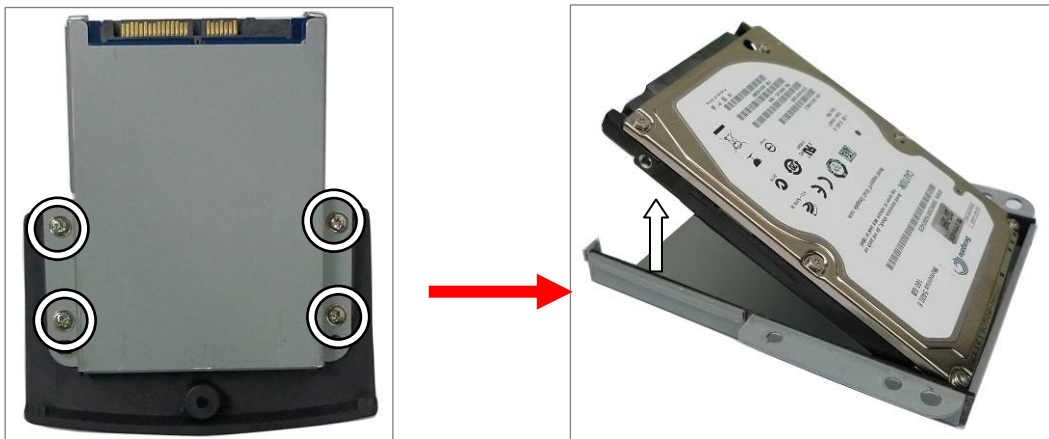

3. Unfasten the screws (x4)
4. Separate the HDD from the metal bracket.

## 4-2 Replace the Power Adapter

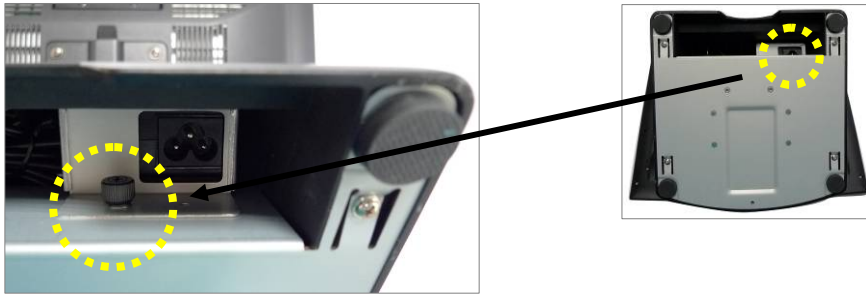

1. Release the thumb screw to separate the retaining metal bracket from the stand and take out the power adapter.

## 4-3 Remove the System Stand



1. Release the screws (x2) that fasten the stand and the system.
2. Release the screws (x4) that fasten the plastic VESA mounting plate and the LCD rear cover.



3. Remove the VESA metal bracket,.

## 5

# Specification

<b>Model Name</b>	<b>EVO-TP2A</b>
<b>Motherboard</b>	<b>C36</b>
CPU Support	Intel Atom N270 processors 1.6G L2 512K FSB 533MHz
Chipset	Intel 945GSE Express chipset + ICH7M
System Memory	1 x DDR2 SO-DIMM up to 2GB
Graphic Memory	Intel GMA 950 share system memory up to 224MB
<b>LCD Touch Panel</b>	
LCD Size	15" TFT LCD
Brightness	250nits
Maximal Resolution	1024 x 768
Touch Screen Type	Resistive
Tilt Angle	0° ~ 90°
<b>Storage</b>	
HDD	One 2.5" SATA HDD bay
Flash Memory	Option SATA SSD flash card
<b>Expansion</b>	
PCI-E Socket	1
<b>External I/O Ports</b>	
USB	4 ports (V2.0)
Serial / COM	4 x RJ-45 COM connectors ( COM1 & COM2 standard RS-232; COM3 & COM4 pin10 with 5V /12V power by jumper )
LAN (10 /100 / 1000)	1 x RJ45
DC Jack	1(19V-IN)
E-SATA interface	DC-OUT, E-SATA
2nd VGA	1
Cash Drawer Port	1 x RJ 11 (12V /19V)
<b>Audio</b>	
Speaker	Option 2 x 2W speakers
<b>Power</b>	
Power Adapter	Ext. 65W, 19V/3.4A

<b>Control / Indicator</b>	
Power Button	1
Indicator LED	1
<b>Peripheral</b>	
MSR module	MSR (USB)
Customer display	2 x 20 VFD customer display (COM)
Second display	8.4" 2nd display without touch
<b>Communication</b>	
Wireless LAN	Option ( 802.11 b/g/n wireless LAN card & antenna )
<b>Environment</b>	
EMC & Safety	FCC/CE Class A, LVD
Operating Temperature	5 °C ~ 40 °C (41 °F ~ 104 °F)
Storage Temperature	-20°C ~ 55 °C (-4 °F ~ 131 °F)
Operating Humidity	20% ~ 80% RH non condensing
Storage Humidity	20% ~ 85% RH non condensing
<b>Dimension (W x D x H)</b>	LCD 90 degree : 365.2 x 296.2 x 282.2 mm
	LCD 0 degree : 365.2 x 217.76 x 343.1 mm
<b>Weight (N.W./G.W.)</b>	5.8kgs / 6.8kgs
<b>Mounting</b>	100mm x100mm VESA Standard holes
<b>OS Support</b>	Windows XP, Windows XP Embedded, Windows CE, Linux

\* This specification is subject to change without prior notice.

# 6 Jumper Settings

## 6-1 C36A V1.1 Motherboard Layout

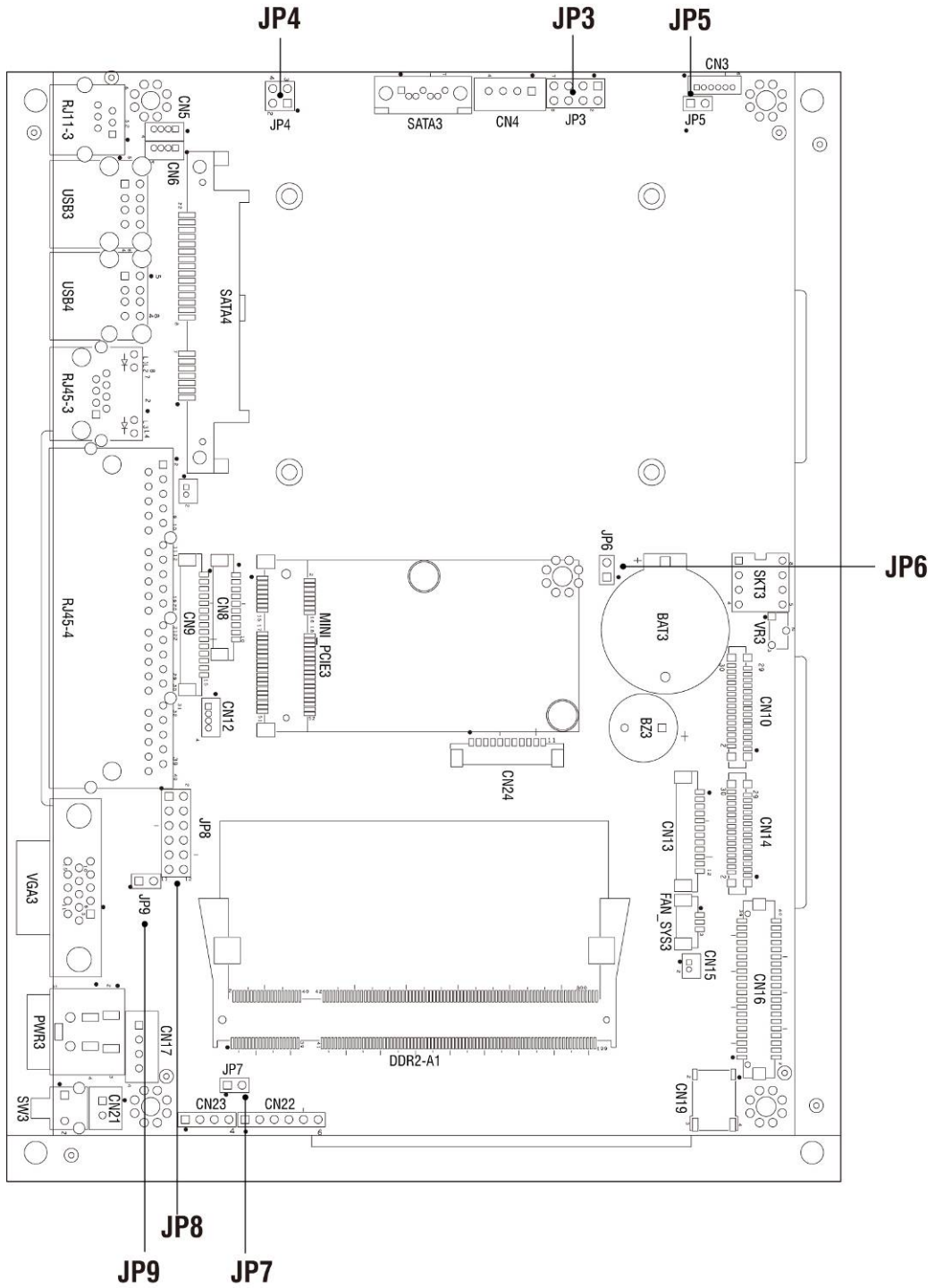

## 6-2 Connectors Description



Connector	Purpose
BAT3	CMOS Battery Base ( Use CR2023)
CN3	Speaker & MIC Connector
CN4	Power Connector For HDD
CN5	USB5
CN6	USB7
CN7	LAN LED
CN9	Card Reader Connector
CN12	IrDA Connector
CN13	Inverter Connector
CN15	Power LED
CN16	LCD Interface Connector
CN17	Internal DC-JACK connector
CN21	Internal Power On Switch Connector
CN22	5 Wire Touch
CN24	FT Status Interface
DDR2_A1	DDR2 SO-DIMM
PWR3	+19V Power Adaptor
RJ11_3	Cash Drawer Connector
RJ45_3	LAN (On Board)
RJ45_4	COM1, COM2, COM3, COM4
FAN_SYS3	System FAN Connector
MINI_PCIE3	Mini PCI-E Socket
SATA3	SATA Connector
SKT3	SPI ROM
SW3	Power On Button
USB3	USB1, USB2
USB4	USB3, USB4
VGA3	VGA Port

## 6-3 Jumper Settings



### 6-3-1 Cash Drawer Power Settings: JP4

Function	JP4 (1-2) (3-4)
+12V	1 3  2 4
⊙+19V	1 3  2 4

### 6-3-2 Power Mode Settings: JP5



Function	JP5 (1-2)
⊙ATX Power	
AT Power	

### 6-3-3 CMOS Operation Mode: JP6

Function	JP6 (1-2)
⊙CMOS Normal	
CMOS Reset	

⊙ = Factory default settings

### 6-3-4 System Reset Settings: JP7



Function	JP7 (1-2)
⊙Normal	
Reset	

### 6-3-5 COM3 & COM4 Power Settings: JP8

Function		JP8 (1-2) (3-4) (5-6) (7-8) (9-10) (11-12)																												
COM3 Pin10	RI	<table border="1"> <tr><td></td><td>1</td><td>3</td><td>5</td><td>7</td><td>9</td><td>11</td></tr> <tr><td>■</td><td>□</td><td>□</td><td>□</td><td>□</td><td>□</td><td>□</td></tr> <tr><td>■</td><td>□</td><td>□</td><td>□</td><td>□</td><td>□</td><td>□</td></tr> <tr><td></td><td>2</td><td>4</td><td>6</td><td>8</td><td>10</td><td>12</td></tr> </table>		1	3	5	7	9	11	■	□	□	□	□	□	□	■	□	□	□	□	□	□		2	4	6	8	10	12
		1	3	5	7	9	11																							
	■	□	□	□	□	□	□																							
■	□	□	□	□	□	□																								
	2	4	6	8	10	12																								
⊙+5V	<table border="1"> <tr><td></td><td>1</td><td>3</td><td>5</td><td>7</td><td>9</td><td>11</td></tr> <tr><td>□</td><td>■</td><td>□</td><td>□</td><td>□</td><td>□</td><td>□</td></tr> <tr><td>□</td><td>■</td><td>□</td><td>□</td><td>□</td><td>□</td><td>□</td></tr> <tr><td></td><td>2</td><td>4</td><td>6</td><td>8</td><td>10</td><td>12</td></tr> </table>		1	3	5	7	9	11	□	■	□	□	□	□	□	□	■	□	□	□	□	□		2	4	6	8	10	12	
	1	3	5	7	9	11																								
□	■	□	□	□	□	□																								
□	■	□	□	□	□	□																								
	2	4	6	8	10	12																								
+12V	<table border="1"> <tr><td></td><td>1</td><td>3</td><td>5</td><td>7</td><td>9</td><td>11</td></tr> <tr><td>□</td><td>□</td><td>■</td><td>□</td><td>□</td><td>□</td><td>□</td></tr> <tr><td>□</td><td>□</td><td>■</td><td>□</td><td>□</td><td>□</td><td>□</td></tr> <tr><td></td><td>2</td><td>4</td><td>6</td><td>8</td><td>10</td><td>12</td></tr> </table>		1	3	5	7	9	11	□	□	■	□	□	□	□	□	□	■	□	□	□	□		2	4	6	8	10	12	
	1	3	5	7	9	11																								
□	□	■	□	□	□	□																								
□	□	■	□	□	□	□																								
	2	4	6	8	10	12																								
COM4 Pin10	RI	<table border="1"> <tr><td></td><td>1</td><td>3</td><td>5</td><td>7</td><td>9</td><td>11</td></tr> <tr><td>□</td><td>□</td><td>□</td><td>■</td><td>□</td><td>□</td><td>□</td></tr> <tr><td>□</td><td>□</td><td>□</td><td>■</td><td>□</td><td>□</td><td>□</td></tr> <tr><td></td><td>2</td><td>4</td><td>6</td><td>8</td><td>10</td><td>12</td></tr> </table>		1	3	5	7	9	11	□	□	□	■	□	□	□	□	□	□	■	□	□	□		2	4	6	8	10	12
		1	3	5	7	9	11																							
	□	□	□	■	□	□	□																							
□	□	□	■	□	□	□																								
	2	4	6	8	10	12																								
+5V	<table border="1"> <tr><td></td><td>1</td><td>3</td><td>5</td><td>7</td><td>9</td><td>11</td></tr> <tr><td>□</td><td>□</td><td>□</td><td>□</td><td>■</td><td>□</td><td>□</td></tr> <tr><td>□</td><td>□</td><td>□</td><td>□</td><td>■</td><td>□</td><td>□</td></tr> <tr><td></td><td>2</td><td>4</td><td>6</td><td>8</td><td>10</td><td>12</td></tr> </table>		1	3	5	7	9	11	□	□	□	□	■	□	□	□	□	□	□	■	□	□		2	4	6	8	10	12	
	1	3	5	7	9	11																								
□	□	□	□	■	□	□																								
□	□	□	□	■	□	□																								
	2	4	6	8	10	12																								
⊙+12V	<table border="1"> <tr><td></td><td>1</td><td>3</td><td>5</td><td>7</td><td>9</td><td>11</td></tr> <tr><td>□</td><td>□</td><td>□</td><td>□</td><td>□</td><td>□</td><td>■</td></tr> <tr><td>□</td><td>□</td><td>□</td><td>□</td><td>□</td><td>□</td><td>■</td></tr> <tr><td></td><td>2</td><td>4</td><td>6</td><td>8</td><td>10</td><td>12</td></tr> </table>		1	3	5	7	9	11	□	□	□	□	□	□	■	□	□	□	□	□	□	■		2	4	6	8	10	12	
	1	3	5	7	9	11																								
□	□	□	□	□	□	■																								
□	□	□	□	□	□	■																								
	2	4	6	8	10	12																								

⊙ = Factory default settings

### 6-3-6 VGA Power Settings: JP9

Function	JP9 (1-2)
⊙No Power	
+12V	

### 6-3-7 Boot Display Device Settings: JP3

Function	JP3 (1-2) (3-4)																				
Force CRT only	<table border="1"> <tr> <td></td> <td>1</td> <td>3</td> <td>5</td> <td>7</td> </tr> <tr> <td></td> <td><input checked="" type="checkbox"/></td> <td><input type="checkbox"/></td> <td></td> <td></td> </tr> <tr> <td></td> <td><input checked="" type="checkbox"/></td> <td><input type="checkbox"/></td> <td></td> <td></td> </tr> <tr> <td></td> <td>2</td> <td>4</td> <td>6</td> <td>8</td> </tr> </table>		1	3	5	7		<input checked="" type="checkbox"/>	<input type="checkbox"/>				<input checked="" type="checkbox"/>	<input type="checkbox"/>				2	4	6	8
	1	3	5	7																	
	<input checked="" type="checkbox"/>	<input type="checkbox"/>																			
	<input checked="" type="checkbox"/>	<input type="checkbox"/>																			
	2	4	6	8																	
⊙Force LCD only	<table border="1"> <tr> <td></td> <td>1</td> <td>3</td> <td>5</td> <td>7</td> </tr> <tr> <td></td> <td><input type="checkbox"/></td> <td><input checked="" type="checkbox"/></td> <td></td> <td></td> </tr> <tr> <td></td> <td><input type="checkbox"/></td> <td><input checked="" type="checkbox"/></td> <td></td> <td></td> </tr> <tr> <td></td> <td>2</td> <td>4</td> <td>6</td> <td>8</td> </tr> </table>		1	3	5	7		<input type="checkbox"/>	<input checked="" type="checkbox"/>				<input type="checkbox"/>	<input checked="" type="checkbox"/>				2	4	6	8
	1	3	5	7																	
	<input type="checkbox"/>	<input checked="" type="checkbox"/>																			
	<input type="checkbox"/>	<input checked="" type="checkbox"/>																			
	2	4	6	8																	

⊙ = Factory default settings

## 6-3-8 LCD ID Settings for LVDS Panel:

Panel Number	Resolution	LVDS		JP3 (5-6) (7-8)												
		Bits	Channel													
1	1024 x 768	24	Single	<table style="border-collapse: collapse; text-align: center;"> <tr> <td>1</td><td>3</td><td>5</td><td>7</td> </tr> <tr> <td><input type="checkbox"/></td><td><input checked="" type="checkbox"/></td><td><input checked="" type="checkbox"/></td><td><input checked="" type="checkbox"/></td> </tr> <tr> <td>2</td><td>4</td><td>6</td><td>8</td> </tr> </table>	1	3	5	7	<input type="checkbox"/>	<input checked="" type="checkbox"/>	<input checked="" type="checkbox"/>	<input checked="" type="checkbox"/>	2	4	6	8
1	3	5	7													
<input type="checkbox"/>	<input checked="" type="checkbox"/>	<input checked="" type="checkbox"/>	<input checked="" type="checkbox"/>													
2	4	6	8													
2	1280 x 1024	24	Dual	<table style="border-collapse: collapse; text-align: center;"> <tr> <td>1</td><td>3</td><td>5</td><td>7</td> </tr> <tr> <td><input type="checkbox"/></td><td><input checked="" type="checkbox"/></td><td><input checked="" type="checkbox"/></td><td><input type="checkbox"/></td> </tr> <tr> <td>2</td><td>4</td><td>6</td><td>8</td> </tr> </table>	1	3	5	7	<input type="checkbox"/>	<input checked="" type="checkbox"/>	<input checked="" type="checkbox"/>	<input type="checkbox"/>	2	4	6	8
1	3	5	7													
<input type="checkbox"/>	<input checked="" type="checkbox"/>	<input checked="" type="checkbox"/>	<input type="checkbox"/>													
2	4	6	8													
3	800 x 600	18	Single	<table style="border-collapse: collapse; text-align: center;"> <tr> <td>1</td><td>3</td><td>5</td><td>7</td> </tr> <tr> <td><input type="checkbox"/></td><td><input type="checkbox"/></td><td><input checked="" type="checkbox"/></td><td><input checked="" type="checkbox"/></td> </tr> <tr> <td>2</td><td>4</td><td>6</td><td>8</td> </tr> </table>	1	3	5	7	<input type="checkbox"/>	<input type="checkbox"/>	<input checked="" type="checkbox"/>	<input checked="" type="checkbox"/>	2	4	6	8
1	3	5	7													
<input type="checkbox"/>	<input type="checkbox"/>	<input checked="" type="checkbox"/>	<input checked="" type="checkbox"/>													
2	4	6	8													
4	1024 x 768	18	Single	<table style="border-collapse: collapse; text-align: center;"> <tr> <td>1</td><td>3</td><td>5</td><td>7</td> </tr> <tr> <td><input type="checkbox"/></td><td><input type="checkbox"/></td><td><input type="checkbox"/></td><td><input type="checkbox"/></td> </tr> <tr> <td>2</td><td>4</td><td>6</td><td>8</td> </tr> </table>	1	3	5	7	<input type="checkbox"/>	<input type="checkbox"/>	<input type="checkbox"/>	<input type="checkbox"/>	2	4	6	8
1	3	5	7													
<input type="checkbox"/>	<input type="checkbox"/>	<input type="checkbox"/>	<input type="checkbox"/>													
2	4	6	8													

⊙ = Factory default settings

**Note:**



**OPEN**



**SHORT**



# 7

## BIOS Settings

### BIOS Main Menu

When the BIOS Main Menu is displayed, the following items can be selected. Use the arrow keys to select items and the Enter key to accept and enter the sub-menu.

**Note:** The BIOS setup menus shown in this section are for reference only and may not exactly match the items of your BIOS version.

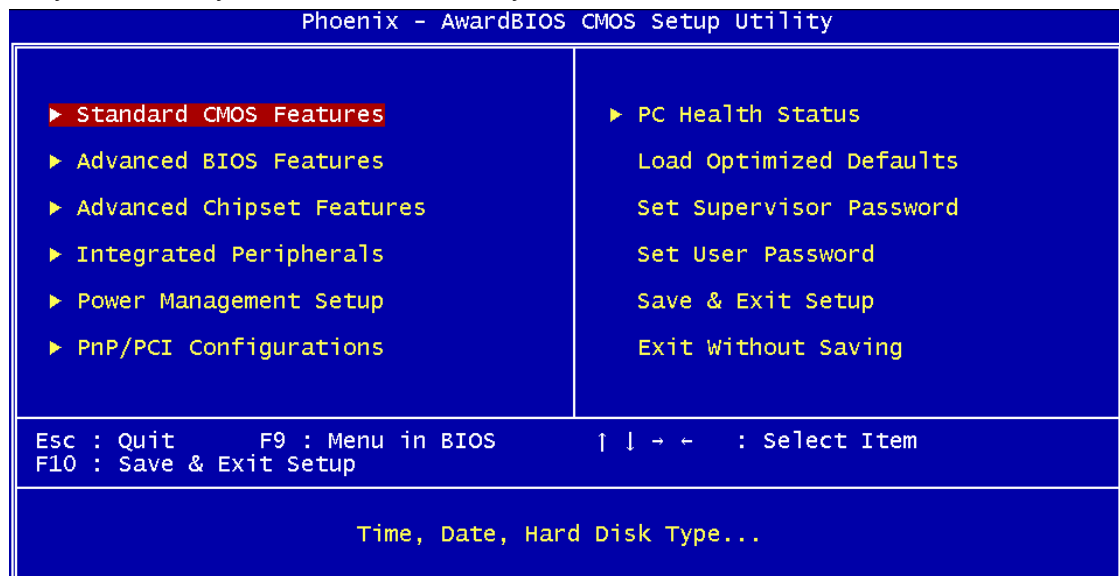

### Standard CMOS Features

Use this menu for basic system configuration.

### Advanced BIOS Features

Use this menu to set the Advanced Features available on the system.

### Advanced Chipset Features

Use this menu to change the values in the chipset registers and optimize the system's performance.

### Integrated Peripherals

Use this menu to specify your settings for integrated peripherals.

### Power Management setup

Use this menu to specify your settings for power management.

**PnP/PCI Configurations**

This entry appears if your system supports Plug and Play and PCI Configuration.

**PC health status**

Displays CPU, System Temperature, Fan Speed, and System Voltages Value.

**Load Optimized Defaults**

Use this menu to load the BIOS default values, i.e., factory settings for optimal performance system operations. While Award has designed the custom BIOS to maximize performance, the factory has the option to change these defaults to meet their needs.

**Set Supervisor Password**

Enables you to change, set, or disable the supervisor or user password.

**Set Password**

Change, set, or disable the password. It allows you to limit access to the system and to the setup, or just to the setup.

**Save & exit setup**

Save CMOS value changes to CMOS and exits setup.

**Exit without saving**

Ignores all CMOS value changes and exits setup.

# Appendix A: Important Notice of Power Switch

To prevent users from accidentally powering the computer down by depressing the power switch. Follow these steps to disable auto power down.

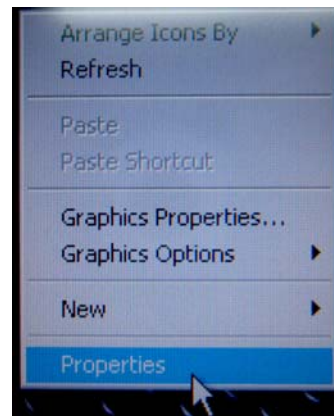

1. Press right mouse button on desktop to reveal the drop-down menu.
2. Select <Properties>.

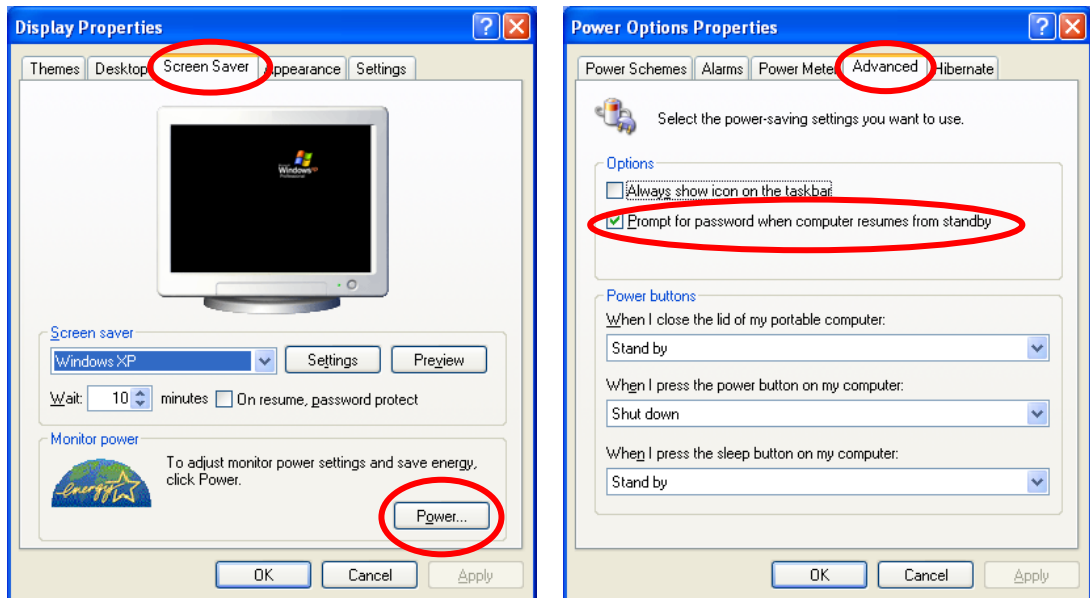

3. Select <Screen Saver> tab and proceed to <Power> button.
4. Select <Advanced> tab and click the <Prompt for password when computer resumes from standby>.

# **Appendix B:**

## **Drivers Installation:**

The shipping package includes a Driver CD. You can find every individual driver and utility that enables you to install the drivers in the Driver CD.

Please insert the Driver CD into the drive and double click on the “index.htm” to pick up the models. You can refer to the drivers installation guide for each driver in the “Driver/Manual List”.